

PTZ 10

10x optical zoom camera

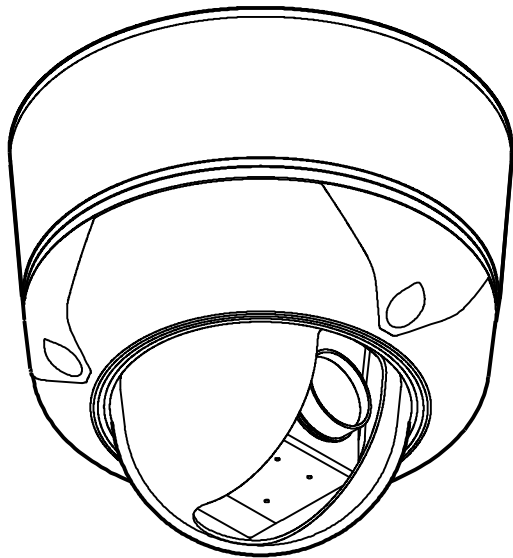

Baek Enterprise Ltd.

Important Features

- 1/4" Sony Super HAD CCD
- 10x optical zoom, 10x Digital zoom, total 100x
- 6.6 inch bubble vandal proof, polycarbonate.
- 360° Endless (Pan) vertical - 92° (Tilt)
- Max speed: Pan 360°/sec, Tilt: 200°/sec (On preset mode)
- WDR (on/off/auto)
- Day & Night of Mechanical Filter change (o. 1Lux)
- Sensitive up to 0.003 Lux
- 64 Camera Angle Preset Positions
- Alarm: 4CH Active high/low selective input, 1 Relay output
- Various Surveillance Mode included Swing, Tour, Group, Trace and etc.
- For External Use Type, Built in Fan/Heater
- Weather Proof (IP Rate: 66) * CE, FCC

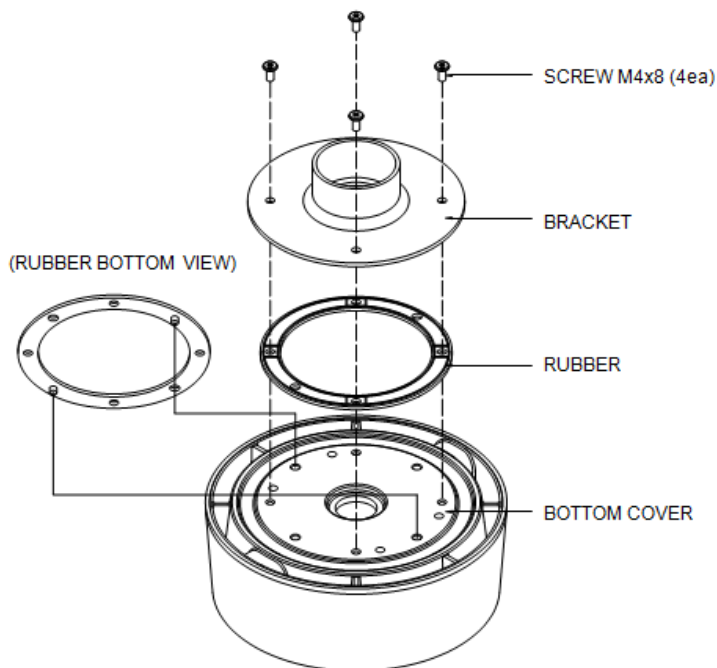

Technical Document

Technical specification

PAN /TILT	Pan Rotation Angle		360° Endless
	Pan Speed	Manual	100° ~ 150°/sec
		Preset	Max 200° /sec
	Tilt Rotation Angle		0° ~ 90°
	Tilt Speed	Manual	100° ~ 150°/sec
		Preset	Max 200° /sec
System Accuracy		0.2°	
FUNCTIONS	Presets		165 positions with a 16-character label available for each position with different speed steps
	Group Tour		Max. 8 Programmable group tours (each one consisting of up to 60 preset steps with different steps)
	Auto scan		Programmable Auto scan
	Pattern		8 Programmable Patterns (total 480 seconds)
	Privacy Zone		4 privacy zones -
	Sector		8 selectable Sectors with 16 characters
	Password Protection		Yes
	Alarm Input		4 alarms OFF/NC/NO (with various programmable states)
	Alarm Actions		Activate preset, Group scanning or Patterns
	Auto Flip		ON / OFF
	OSD Menu		Multiple Languages on screen
	Communication		RS-485
Protocol		Pelco D/P, Vicon, Samsung	
POWER	Consumption (12V DC)		9W Max (Heater Type 15W)
	Consumption (24V AC)		18W Max (Heater Type 30W)
	Power Supply(12V DC)		DC12V 750mA (Heater Type DC12V 1.2W)
	Power Supply(24V AC)		AC 24V 650mA (Heater Type AC24V 1.3W)
OTHERS	Construction		die-casting , Anti-vandal dome cover
	Dimensions		158.8φ (D) * 163.0mm(H)
	Weight		1.5 kg
	Motor Type		Stepper Motor
	Micro Steps		1/4 Step
	Storage Temperature		-10°C ~ 60°C
	Operating Temperature		0°C ~ 50°C
	Certifications		CE, FCC, IP66
CAMERA MODULE	Image Sensor		1/4" Sony Super HAD CCD
	Total Image Pixels	NTSC	811(H) * 508(V) 410K
		PAL	795(H) * 596(V) 470K
	Number Of Effective Pixels	NTSC	768(H) * 494(V) 380K
		PAL	752(H) * 582(V) 440K
	Horizontal resolution		More Than 500TV Lines
	Lens	Optical	10x Optical Zoom (F=3.8 to 38mm)
		Digital	10x (100x with optical)
	Day & Night (ICR)		Auto/ Day/ Night
	Min. Shooting Distance		0.35m(Wide)/0.8m(Tele)
	Digital Slow Shutter		2/4/8/16/24/32/64/128/ OFF
	Min. illumination	Normal mode	0.7Lux (50IRE)
		Night mode	0.02Lux (ICR On)
	Luminance S/N Ratio		More than 50dB
	Video Output		VBS:1.0Vp-p/75 Ohm
	BLC		ON / OFF
Flicker less	NTSC	ON / OFF (1/100)	
	PAL	ON / OFF (1/120)	
WHITE BALANCE		AWB/ATW/INDOOR/ OUTDOOR	

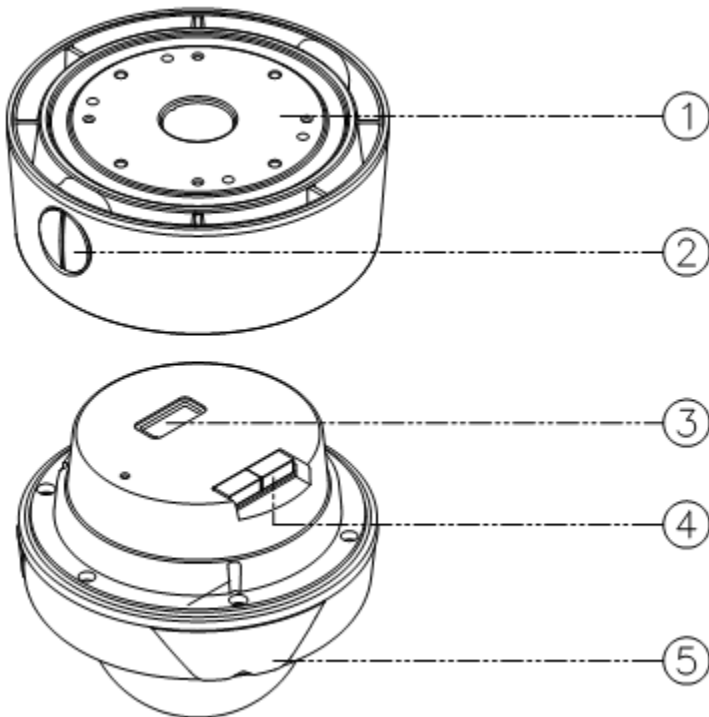

- 1. Surface Mount Adaptor
- 2. Cap Screw (PT3/4 , 1EA)
- 3. Dip Switch
- 4. Terminal Block
- 5. Main body

Baek Enterprise Ltd.

Installers stamp

